

Drawings / Zeichnungen:
AvanTech YOU

Technik für Möbel

Hettich

| | |
|---|----------------------|
| Model / Ausführung | Drawer / Schubkasten |
| Profile height / Zargenhöhe | 101 mm |
| Cabinet side panel thickness / Korpuseitendicke | 16 / 18 / 19 mm |

Quadro YOU

| Nominal length mm | Hole spacing b1 mm | Internal drawer / internal pot-and-pan drawer Minimum cabinet body depth mm |
|----------------------|-----------------------|--|
| 270 | 160 | 291 |
| 300 | 160 | 321 |
| 350 | 224 | 371 |
| 400 | 224 | 421 |
| 450 | 256 | 471 |
| 500 | 256 | 521 |
| 550 | 256 | 571 |
| 600 | 256 | 621 |

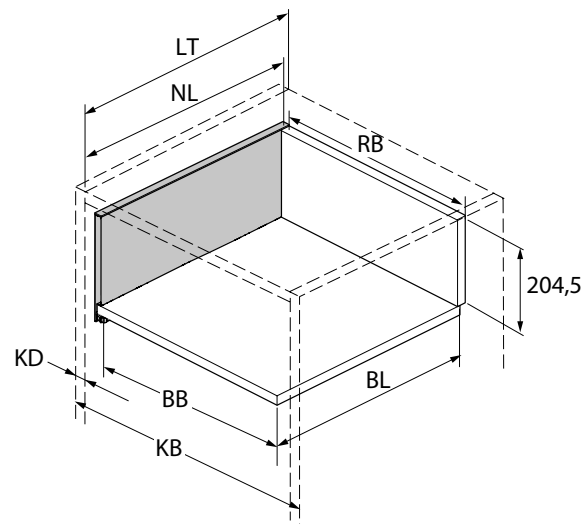

Actro YOU

| Nominal length mm | Hole spacing b1 mm | Hole spacing b2 mm | Internal drawer / Internal pot-and-pan drawer Minimum cabinet body depth mm |
|----------------------|-----------------------|-----------------------|---|
| 270 | 160 | | 282 |
| 300 | 160 | | 312 |
| 350 | 224 | | 362 |
| 400 | 224 | | 412 |
| 450 | 256 | 288 | 462 |
| 500 | 256 | 320 | 512 |
| 550 | 256 | 320 | 562 |
| 600 | 256 | 320 | 612 |
| 650 | 256 | 416 | 662 |

| Measurement / Maß | Wooden rear panel / Holzrückwand |
|----------------------|-------------------------------------|
| BL | 629 |
| BB | LB - 24 |
| RB | LB - 41 |
| D | 204,5 |

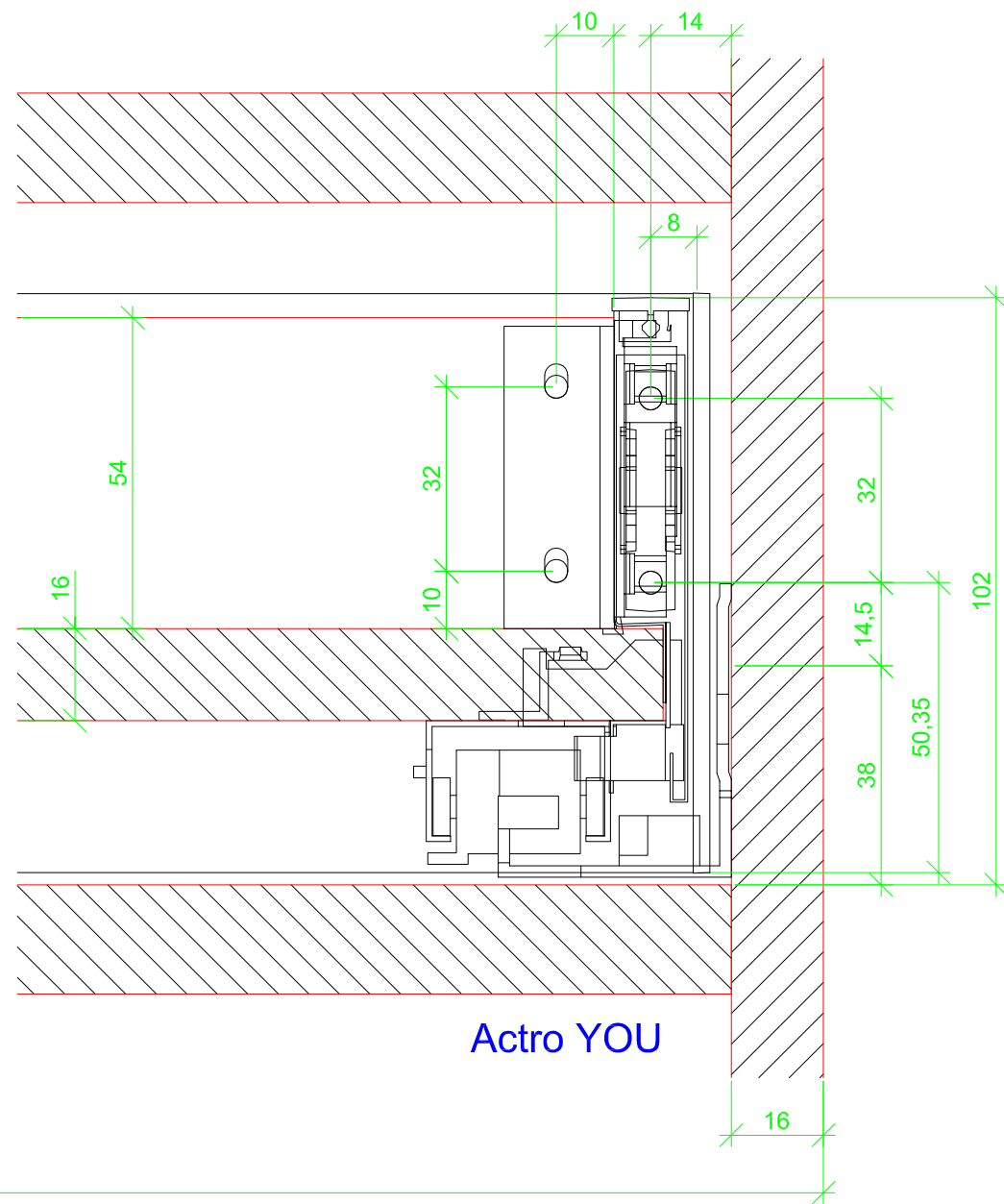
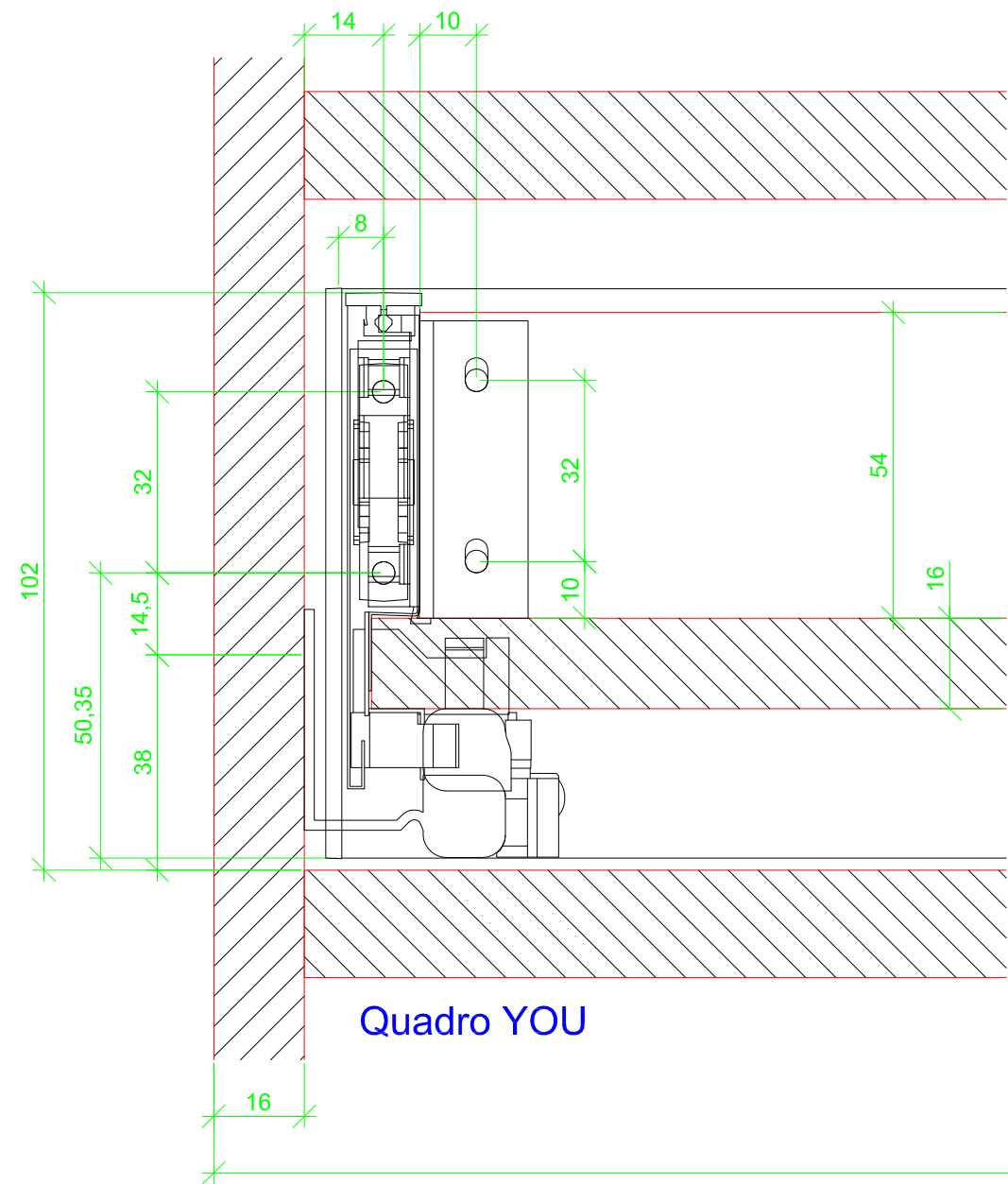

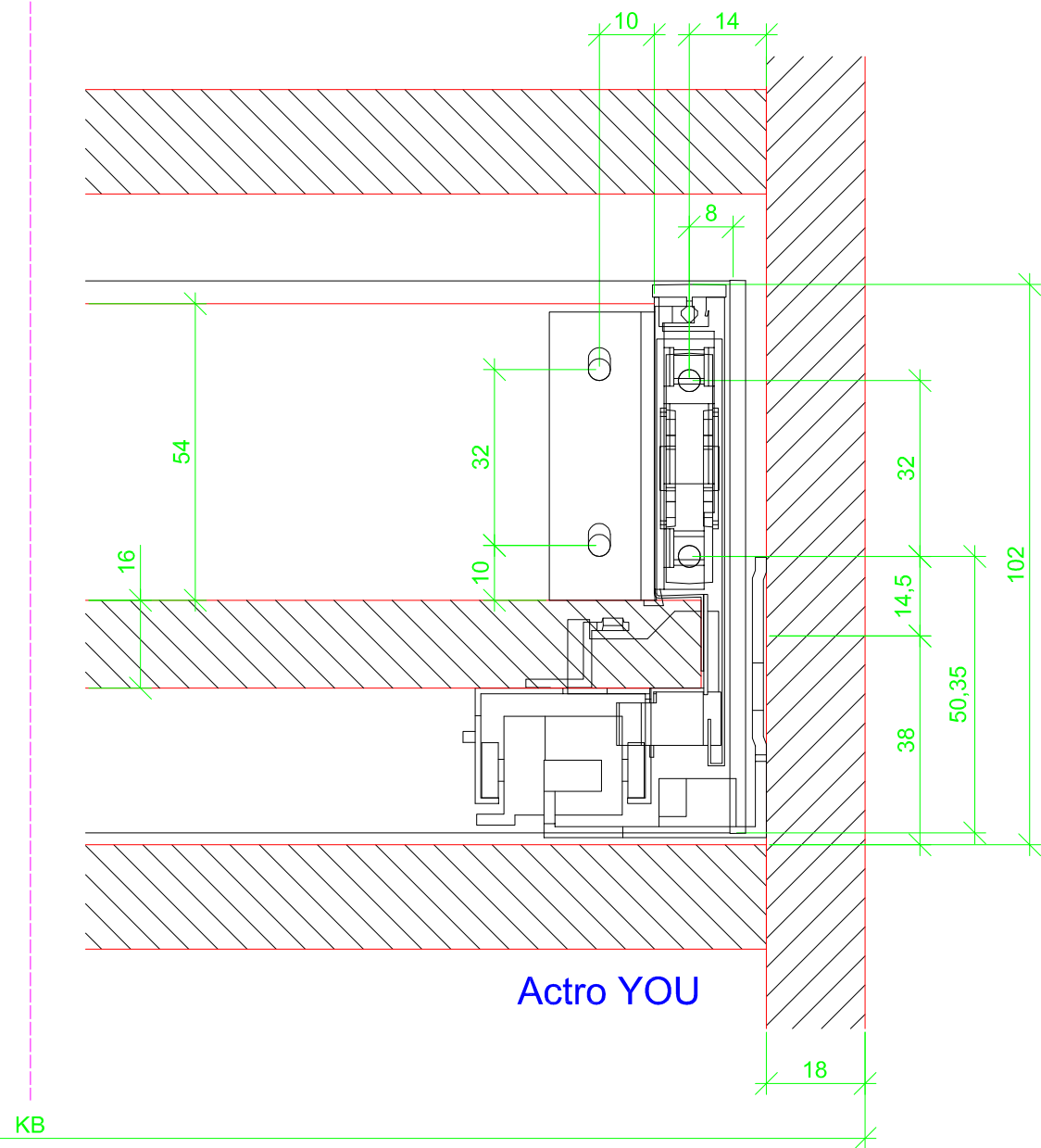
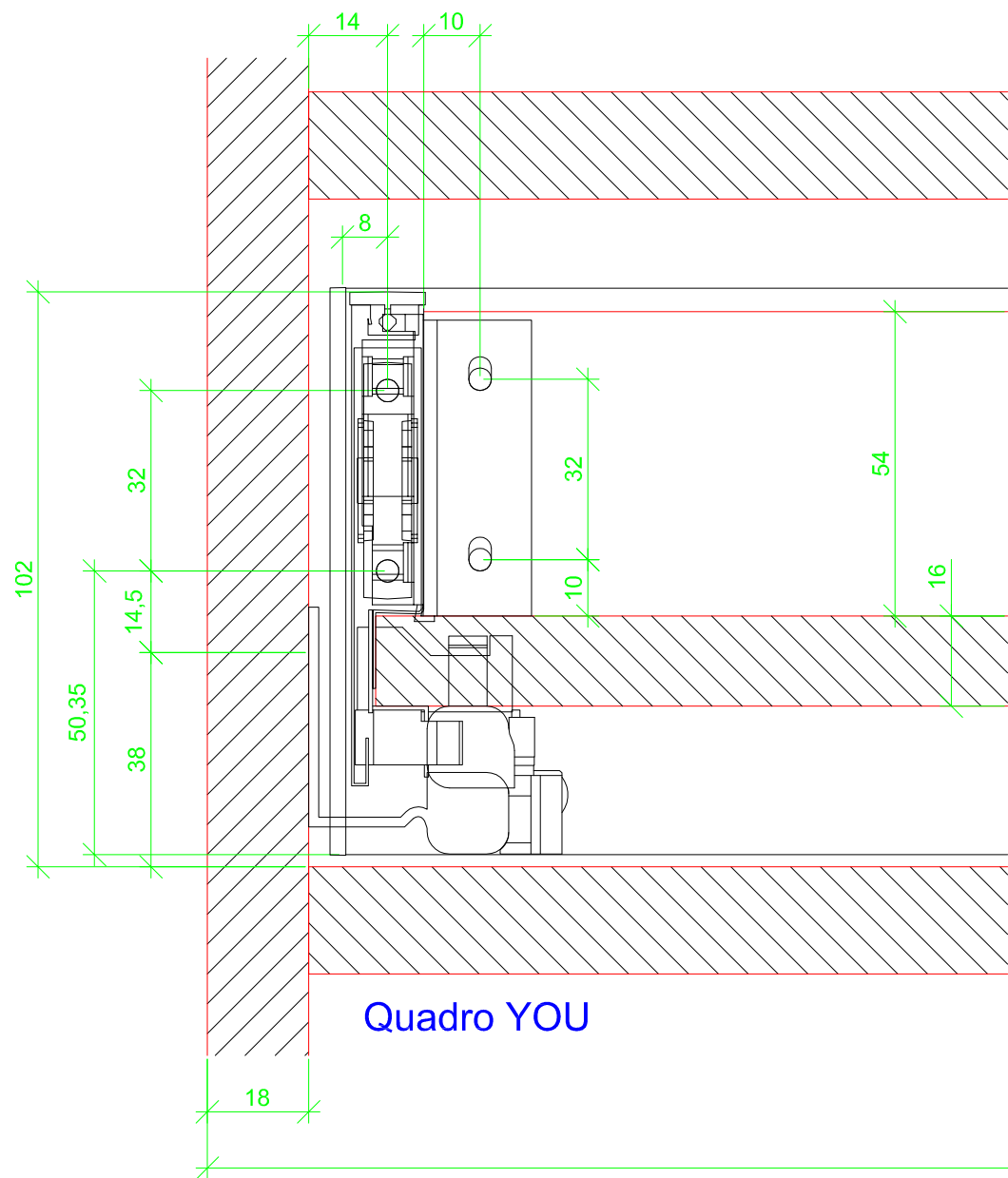

KB

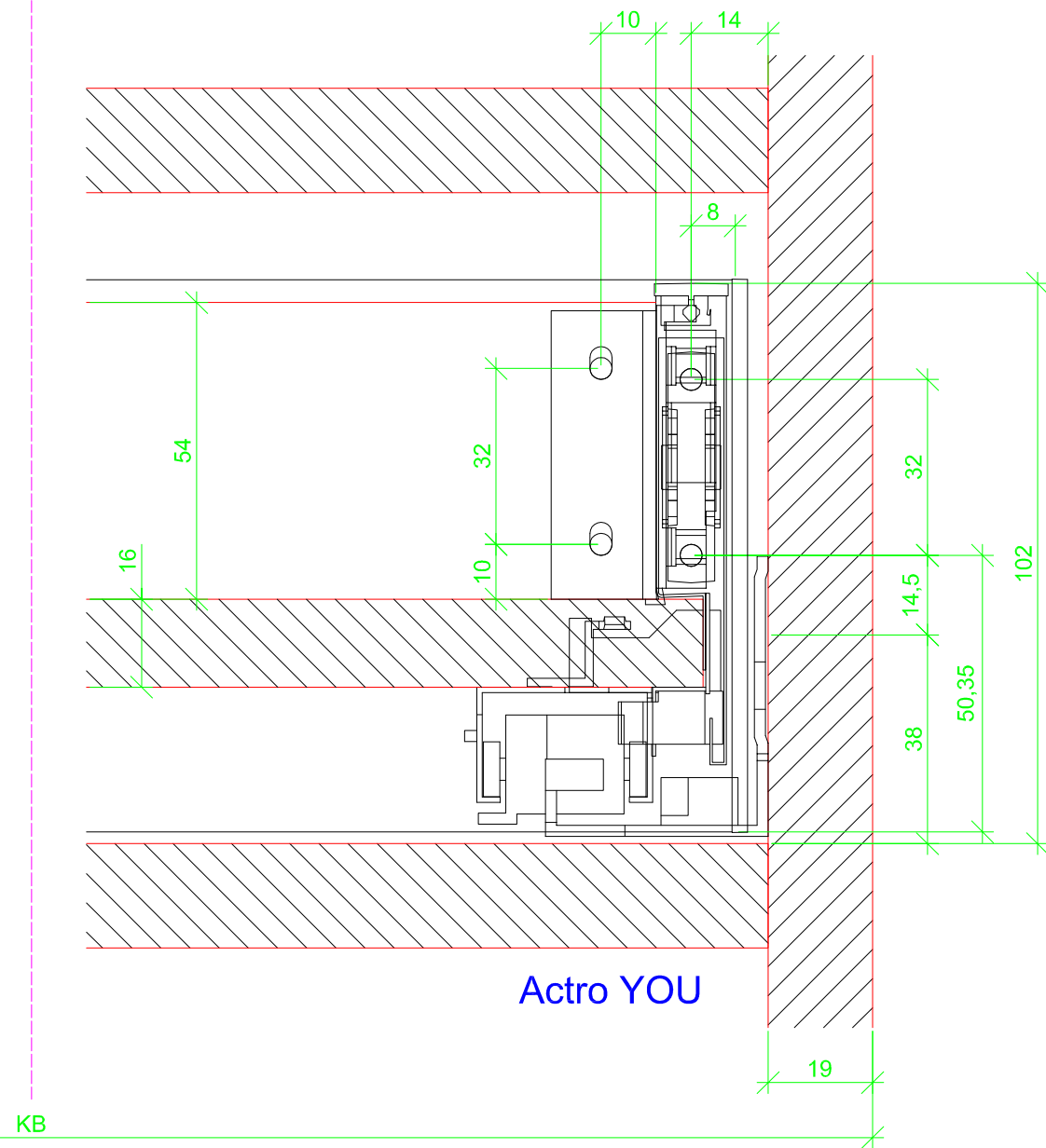
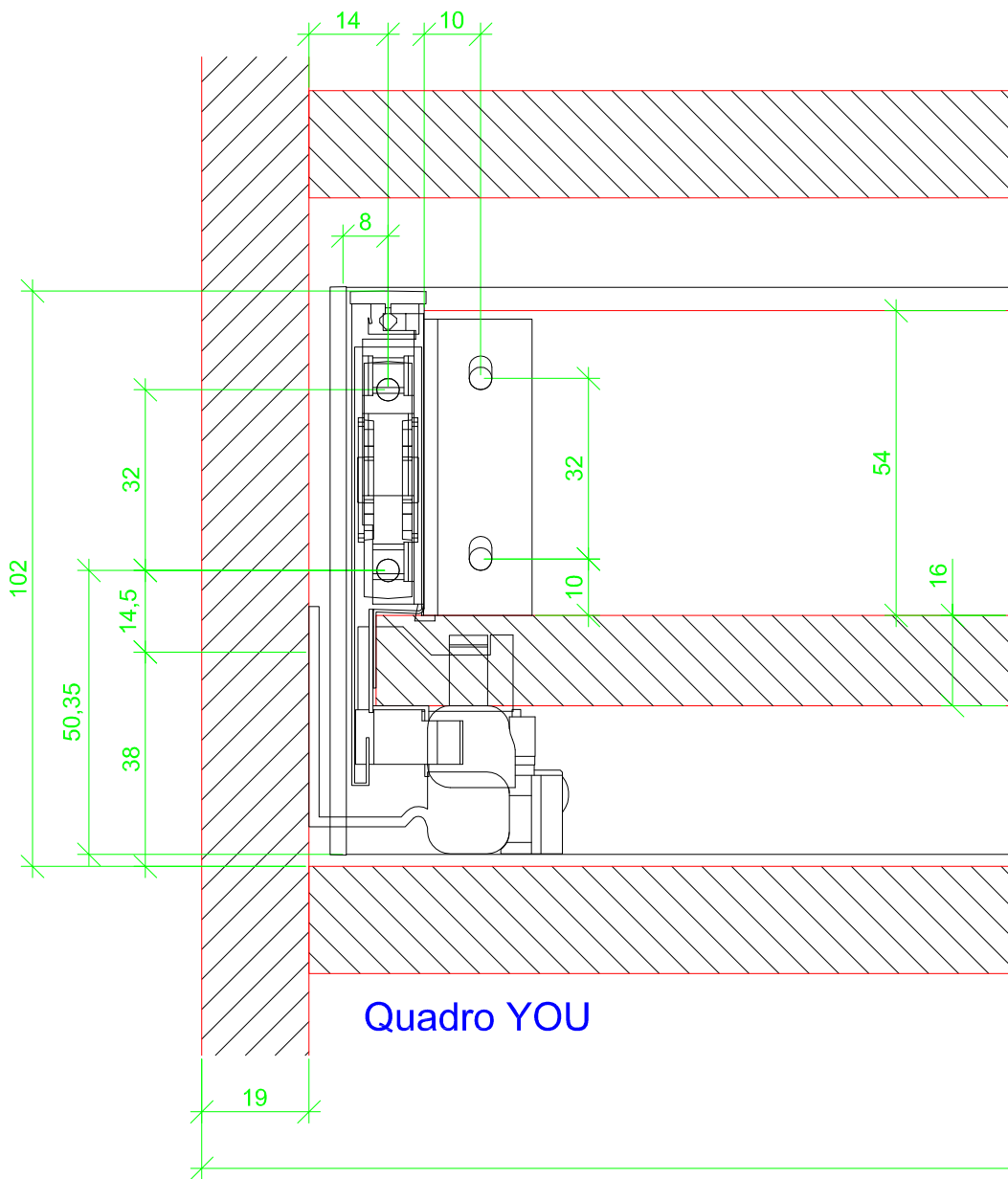

KB

